



# CARLTON GATE ON SITE



12a Beech Court Elmfield Way  
, London, W9 3TT  
Guide price £559,999



## Floor Plan

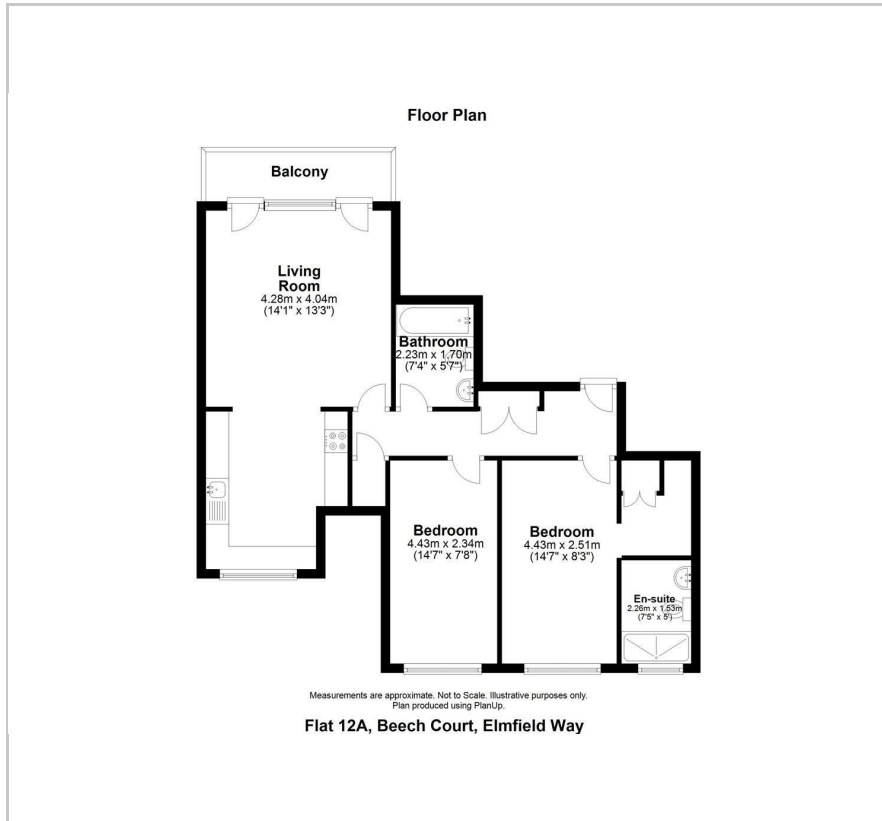

## Area Map



## Energy Efficiency Graph

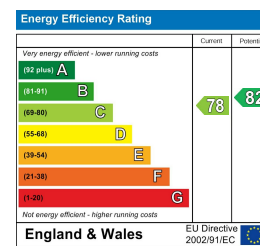

## Viewing

Please contact our Charles Bartlett Residential Office on 07939 496551 if you wish to arrange a viewing appointment for this property or require further information.

- Two bedroom apartment
- Light and spacious
- Second double bedroom
- Open plan living room and kitchen
- Ex-show apartment
- Fourth floor
- Master bedroom with ensuite shower
- Main bathroom
- Balcony with shed
- Underground parking



A superbly presented and exceptionally spacious two-bedroom, two-bathroom apartment set on the fourth floor of the prestigious gated Carlton Gate development near Little Venice and Maida Vale.

Originally designed as the development's show apartment, this impressive home offers bright and well-proportioned accommodation throughout, featuring a generous reception and dining room with direct access to a private balcony, alongside a contemporary open-plan kitchen fitted with a range of integrated appliances.

The master bedroom benefits from fitted wardrobes and a stylish en-suite shower room, whilst the second double bedroom is served by a modern family bathroom. The apartment further benefits from excellent built-in storage throughout and is offered for sale fully furnished, making it an ideal turnkey purchase, London residence or investment opportunity.

Residents of Carlton Gate enjoy a range of premium facilities including 24-hour security, beautifully maintained communal grounds and secure underground parking.

Perfectly positioned, the development is within easy reach of the boutiques, cafés and restaurants of Little Venice, Maida Vale and Warwick Avenue. Westbourne Park, Notting Hill and Paddington are also nearby, providing excellent shopping, leisure and transport connections, including direct services to Heathrow Airport and the Elizabeth Line.



These particulars, whilst believed to be accurate are set out as a general outline only for guidance and do not constitute any part of an offer or contract. Intending purchasers should not rely on them as statements of representation of fact, but must satisfy themselves by inspection or otherwise as to their accuracy. No person in this firm's employment has the authority to make or give any representation or warranty in respect of the property.

The Newt, Denchworth Manor Hyde Road, Denchworth, Oxford, OX12 0DX  
Tel: 07939 496551 Email: charles@charlesbartlett.co.uk www.charlesbartlett.co.uk